

UB SDR 9

Coupler without inner stop, SDR 9

Coupler UB SDR 9 without inner stop

- Gas, water and H₂
- Maximum pressure: Gas 10 bar; Water 20 bar
- Material; PE 100
- Safety technology
- DVGW test mark: DV-8601AU2248, DV-8606AU2249, DV-8611AU2250 and DW-8610CN04200
- FM Approvals Class: 1613 (d 400 - d 500)

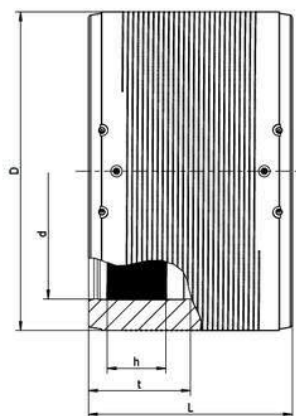

PE 100 SDR 9

Maximum permissible working pressure 20 bar (water) / 10 bar (gas)



SKU	d	SDR range	B	D	h	L	t	Weight Kg	BX	PU
615075	400	9 – 17,6	500	500	90	320	160	20,800	1	4
615076	450	9 – 17,6	560	560	79	340	170	30,000	1	4
615124	500	9 – 17,6	630	630	80	360	180	40,000	1	2
616312	560	9 – 17,6	715	715	95	380	190	55,000	1	2
616269	630	9 – 17,6	810	810	101	420	210	79,600	1	2

Please note the mandatory labels directly on the product. DVGW test marks issued: DV-8601AU2248, DV-8606AU2249 and DV-8611AU22500.



UB SDR 9

Coupler without inner stop, SDR 9

Areas of Application

The FRIALEN-Coupler UB is used for cut and lay pipe connections.

Additional areas of application:

- Integration of adapters into an existing pipeline
- Connection of pipelines with fixed or restraint points
- Reinforcement / sealing of localised pipe damage
- Reinforcement of pinch points on small dimensions

Assembly Instructions

The fusion of pipe ends with the FRIALEN-Coupler UB takes place using FRIALEN-fusing – leakproof and longitudinally strong.

The pipe ends are prepared according to the general installation instructions (see "Assembly Instructions" for "FRIALEN-Safety Fittings for house connections and distribution pipes up to d 225" and "FRIALEN-Special Technology for laying large bore pipes and relining pipe networks"). This involves removing the oxide skin and cleaning the pipe ends. Please note that spigot of valves must be at least half as long as the coupler.

To compensate a larger annular gap (> 1 mm, max. 3 mm) between coupler and pipe, the pre-heating barcode can be used for couplers UB from d 400 (see instructions packed up with the coupler).

For removal of the oxide layer, FWSG scraper tools are available which facilitate a uniform swarf removal and a reproducible quality of the fusion area preparation.

Good reasons for using the FRIALEN-Slide-over Coupler UB:

- Large coupler depth for ease of pipe guiding (no holding clamps required)
- Extra wide fusion zones
- Maximum stability through great wall thickness
- Cold zones at the front side and in the middle of the coupler
- Exposed heating coil for direct heat transmission to the pipe
- Small annular gap for build-up of optimum joining pressure in the fusion zone
- Touch proof electric contacts
- Fusion indicators for visual fusion control
- From d 400: pre-heating technique for an optimal gapbridging
- From d 400: External reinforcement for an ideal fusion pressure
- Durable batch marking
- Individually wrapped for dirt protection
- Additional barcode for tracing back the fitting (Traceability-Coding)

